

## Digital Timer



## Application

Plastic, rubber, equipment	Semiconductor electronic components industry	Food related industry
Injection molding machinery Extruding machinery Mold temperature controllers Vacuum forming Blow molding (Thermo foaming)	Preheater Cleaning equipment Mold equipment Bonding machine Diffusion equipment	Refrigerating machine (General, for fishing vessel) Dryer Humidifier Bakery, confectionery equipment
Electric furnaces	Pottery manufacturing Ceramic and Glass industry	Packing machine industry
Baking furnace Heavy oil, gas furnaces Incinerator Aluminum, tin, lead, zinc melting furnace Vacuum furnace	Ceramic industry Glass industry Porcelain enameling Grind stone manufacturing	Bag-making machinery Filling packing machinery Hot blast sealing Shrinking packing machinery

# Features

1. Digital setting precisely.
2. LED display for clear monitoring.
3. Multi-function.
4. Panel Size: DIN 48x48. Standard 8 PIN plug.
5. High accuracy. Long mechanical life.
6. SH48S: H/M/S is selectable. DT48 M/S is selectable. TD48 needs to be ordered for H or M or S.

# Panel Function

## SH48S

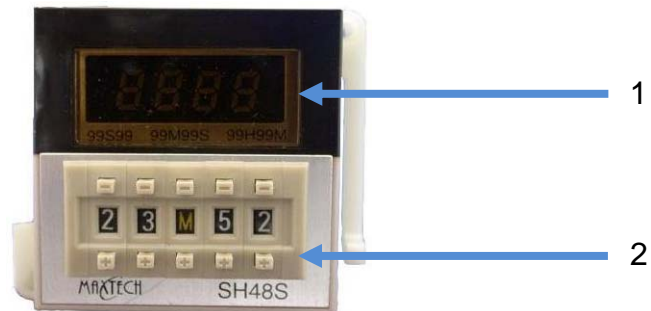

MARKS/DESCRIPTION		DESCRIPTION	
1	LED Digital Indicator	2	Main Control Setting

## TD48

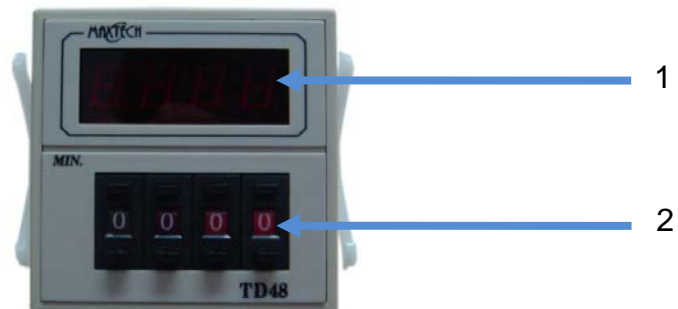



MARKS/DESCRIPTION		DESCRIPTION	
1	LED Digital Indicator	2	Main Control Setting

## DT48



MARKS/DESCRIPTION DESCRIPTION			
1	Digital Indicator	3	Time Switch
2	Time Switch	4	Main Control Indicator

## Standard Specification

Model		SH48S	TD48			DT48
Products						
Products		48Hx48Wx95D (mm)	48Hx48Wx97D (mm)			48Hx48Wx97D (mm)
Mounting & Socket	Surface(-N)	P2CF-08	P2CF-08			P2CF-08
	Flush(-Y)	Y48& P3G-08 or Y48 & US08	Y48& P3G-08 or Y48 & US08			Y48& P3G-08 or Y48 & US08
Full Timing Range		1M~99H 99M 1S~99M 99S 0.01S~99.99S	SEC: 99.99, 999.9, 9999 MIN: 99.99, 999.9, 9999, 99.59 HR: 9.59			0~999.9S , 0~9999S 0~9999M , 0~9999M
Rated Voltage		24V~240V AC/DC	24V~240V AC/DC			AC(V):24 , 120 , 240 DC(V)12 , 24
Contact	Model	A	A	B	C	A
	Time Limit 1C	3A	5A	x	5A	5A
	Time Limit 1C	x	x	5A	x	x
	Instantaneous 1C	3A	5A	x	x	5A
Mechanical Life		10 <sup>7</sup> TIMES	10 <sup>6</sup> TIMES			10 <sup>7</sup> TIMES
Electrical Life		10 <sup>5</sup> TIMES	10 <sup>5</sup> TIMES			10 <sup>5</sup> TIMES
Accuracy	Repeat Error	±0.3%±0.05 SEC	0.05 SEC MAX			0.05 SEC MAX
	Setting Error	<0.3%±0.05 SEC	<0.3%±0.05 SEC			<0.3%±0.05 SEC
	Voltage Error	0	0			0
	Temp Error	±0.2% MAX	±0.2% MAX			±0.2% MAX

<b>Resetting Time</b>	0.1 SEC MAX	0.1 SEC MAX	0.1 SEC MAX
<b>Consumed Power</b>	2VA	2VA	2VA
<b>Ambient Temperature</b>	-10°C~+50°C	-10°C~+50°C	-10°C~+50°C
<b>Ambient Humidity</b>	45~85% RH	45~85% RH	45~85% RH
<b>Weight</b>	220G	210G	120G

## External Dimension

Unit : mm

### SH48S

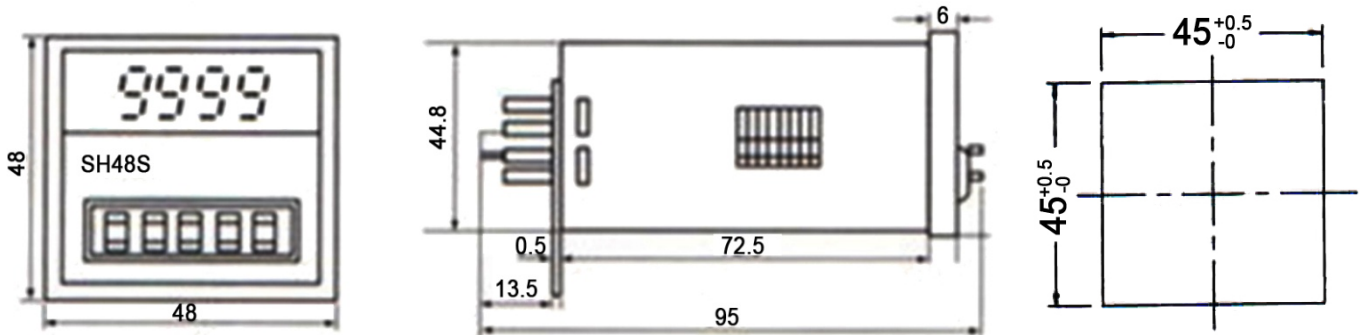

### TD48、DT48

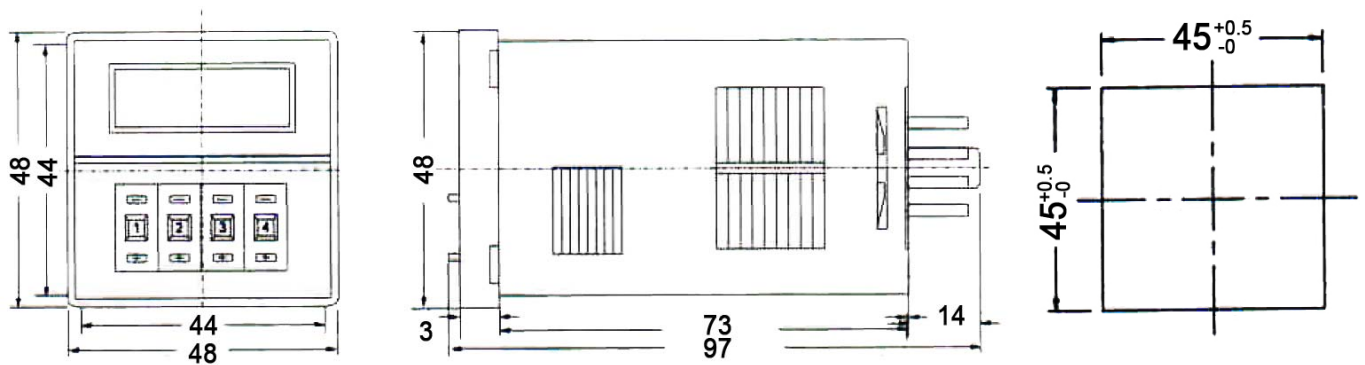

# Socket Base

Unit : mm

## P2CF-08

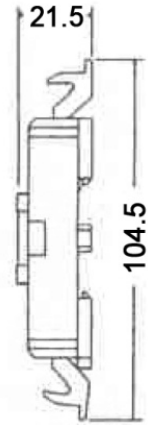
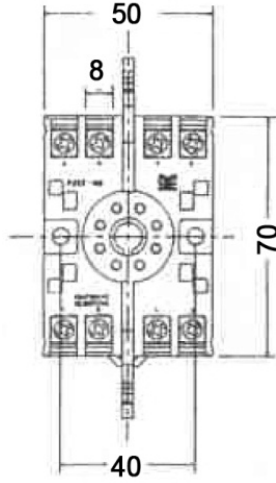

## P3G-08

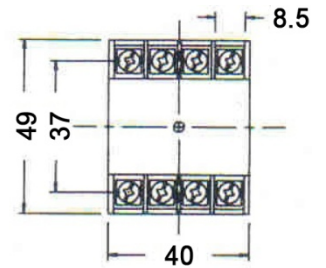
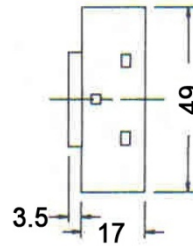
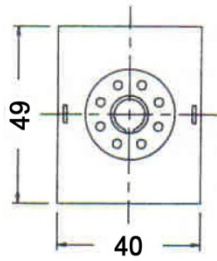
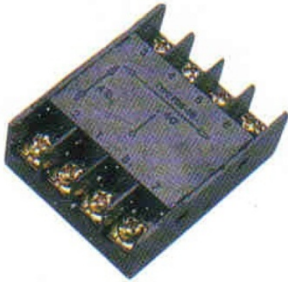

## US08

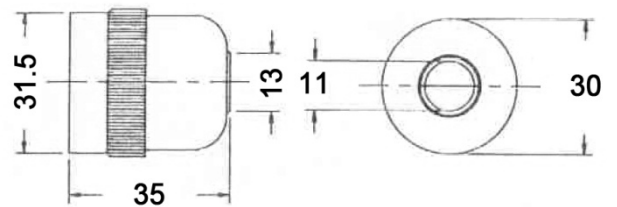
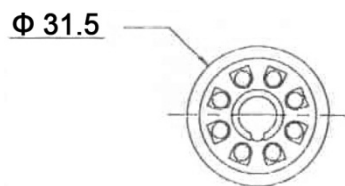

# Contact

## Taipei World Trade Center

Add: 3C22-23 & 3C25-26, Taipei World Trade Center, No. 5, Sec. 5, Hsin Yi Rd. Taipei Taiwan, R.O.C.

Tel: 886-2-27206601 (Rep.)

Fax: 886-2-23455120

E-mail: [gitta@ms9.hinet.net](mailto:gitta@ms9.hinet.net)

<http://www.maxthermo.com>

## Factory

Add: 11F., No.168, Jiankang Rd., Zhonghe Dist., New Taipei City 235, Taiwan (R.O.C.)

Tel: 886-2-22287950 (Rep.)

Fax: 886-2-22286140

## Thailand Office - THAI MAXIMUM ELECTRONIC CO., LTD

Add: 86/132-133 m.7 Samaedum Bangkoontien Bangkok 10150 Thailand.

Tel: +662-415-8318 , +662-417-2548-49

Fax: +662-415-8798

<http://www.thaimaximum.com>