

- Enclosed plug-in style relay.
- Quick connect receptacles or direct soldering.
- Large capacity 30A contact rating.
- 1X, 1Y, 1Z contact arrangement.
- BTA5 general-purpose relay is available in a wide choice of AC or DC voltage with indicator lamp and push to test button.
- **LR** E115915

## ⇒ Contact rating

		BTA5-1X/1Y/1Z
Contact capacity resistive load (Cos.=1)		30A 28VDC
		30A 300VAC
Motor	120VAC	1HP

## ⇒ Coil rating

Rated voltage (V)		Coil resistance (Ω)	Max. pull-in voltage	Min. dropout voltage	Max. allowable voltage	Power consumption
DC	1X	6	80 Max.	10 Min.	110 Max.	Approx. 1.2W
		12				
	1Y	24				
		48				
	1Z	110				
		120				
AC	1X	6	85 Max	30 Min.	110 Max.	Approx. 3VA
		12				
	1Y	24				
		110				
	1Z	120				
		220				
		5500				
		240				
		7200				

# RELAYS & COMPONENTS BTA5

## Specifications

Contact resistance	50mΩ maximum
Operate time	AC: 30mS maximum. DC: 20mS maximum
Release time	AC: 30mS maximum. DC: 20mS maximum
Insulation resistance	1000MΩ minimum at 500VDC.
Dielectric strength	Between open contact: 1000 VAC for 1 minute
	Between contact and coil: 1500VAC for 1 minute
	Between live parts and ground: 1500VAC for 1 minute
Temperature (operating)	-30°C to +50°C (AC); -30°C to +60°C (DC)
Mechanical life	10,000,000 operations
Electrical life	100,000 operations
Contact material	AgCdO/ AGSNO2
Weight (approx.)	87g

## Terminal style:

**Standard terminal: code S**

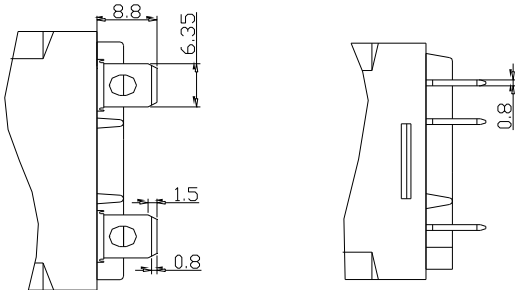

**P.C.B. terminal: code P1**

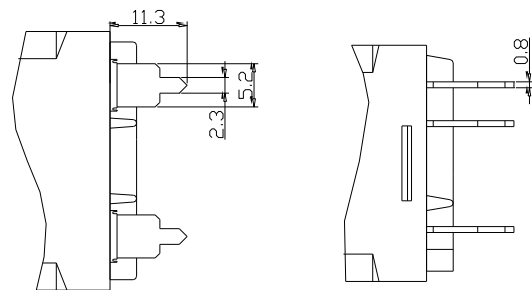

## Cover style:

**Plain cover: code C**

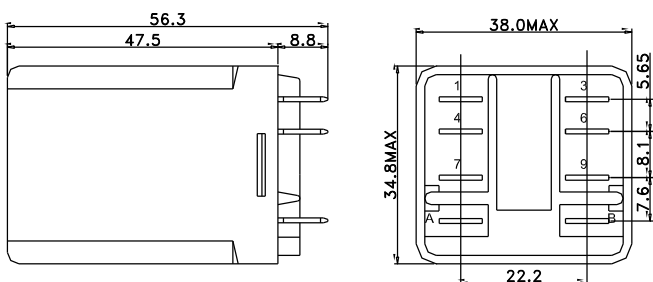

**Side flange cover: code C1**

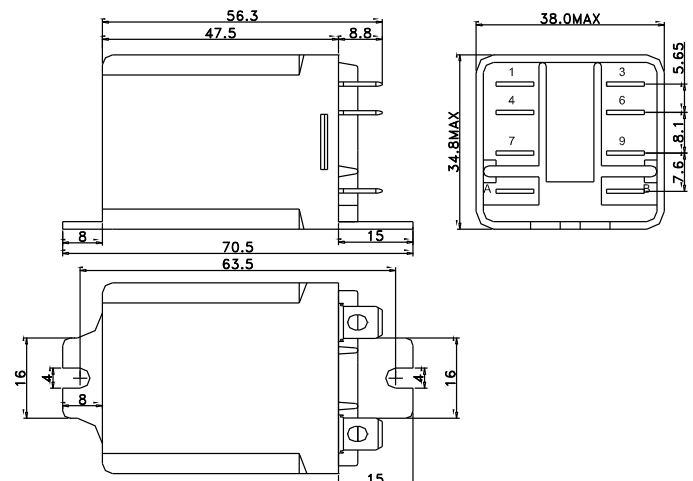

# RELAYS & COMPONENTS BTA5

**Top flange cover: code C3**

**Push button diagram: Code M**

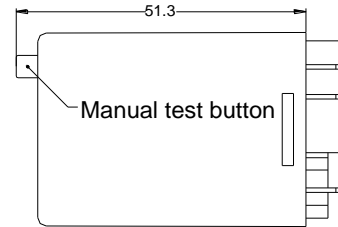
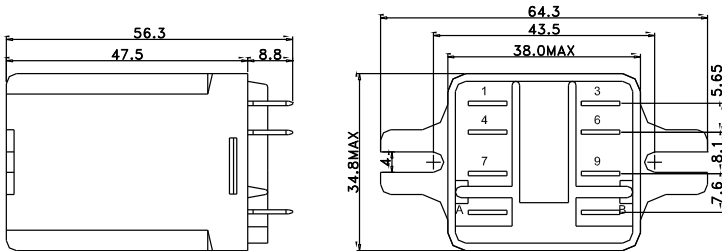

## ⇒ Wire diagrams: (Bottom View)

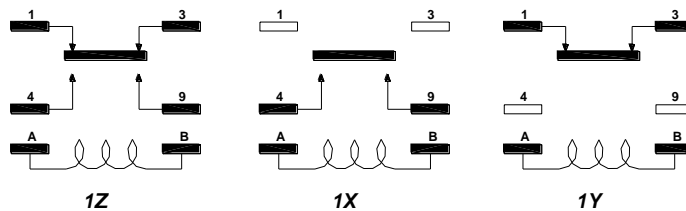

## ⇒ How to order

**BTA5-1Z A - S - C L M - 12 VAC**

**Coil voltage**  
**Options**

- N:** Neon lamp    **M:** Manual push button
- L:** single-polar LED (AC), bi-polar LED (DC)
- L1:** single-polar LED (A=+)    **L2:** single-polar LED (A=-)
- V:** DC coil suppression (A=-)    **V0:** DC coil suppression (A=+)
- V1:** AC coil suppression    **V2:** half wave rectified (A=-)
- V3:** half wave rectified (A=+)    **V4:** bridge rectified

**Cover style**

- C:** plain cover    **C1:** side flange cover    **C3:** top flange cover
- C4:** din rail cover    **C2:** 6-32 Tapped crop and anti-rotation lab

**Terminal style**

- S:** 6.35X0.8    **S1:** 4.8X0.8    **S2:** 4.8X0.5
- P1:** 2.3X0.8    **P2:** 1.2X0.8

**Contact material**

- Blank:** AGCDO    **F:** AGCDO gold diffused
- C:** silver gold diffused    **B:** AGSNO2 gold flashed
- E:** AGCDO gold flashed    **D:** AGNI gold flashed
- G:** silver

**Contact rating**

**Blank:** 30A

**Contact arrangement**

- 1X:** SPNO    **1Y:** SPNC    **1Z:** SPDT    **1XS:** 3mm

**SERIES**